

## USB (TYPE-C) CHARGER

| Accessory Name                  | Parts Number  | Application           | Issue Date     | Publication No. |
|---------------------------------|---------------|-----------------------|----------------|-----------------|
| USB (TYPE-C) CHARGER UNIT       | 08E71-K0F-JF0 | DAX125<br>MONKEY 125M | September 2024 | MII 55245       |
| USB (TYPE-C) CHARGER ATTACHMENT | 08U70-K0F-JF0 |                       |                |                 |

### Introduction

ALL INFORMATION, ILLUSTRATIONS, DIRECTIONS AND SPECIFICATIONS INCLUDED IN THIS PUBLICATION ARE BASED ON THE LATEST PRODUCT INFORMATION AVAILABLE AT THE TIME OF APPROVAL FOR PRINTING. Honda Motor Co., Ltd. RESERVES THE RIGHT TO MAKE CHANGES AT ANY TIME WITHOUT NOTICE AND WITHOUT INCURRING ANY OBLIGATION WHATSOEVER. NO PART OF THIS PUBLICATION MAY BE REPRODUCED WITHOUT WRITTEN PERMISSION. THIS MANUAL IS WRITTEN FOR PERSONS WHO HAVE ACQUIRED BASIC KNOWLEDGE OF MAINTENANCE ON Honda MOTORCYCLES, MOTOR SCOOTERS, ATVS OR SXS's.

Honda Dealer:





Please give a copy of these instructions to your customer.

Customer:

Because the installation of this accessory requires specialized knowledge, special tools and equipment, it is recommended to only install it at a dealer with qualified technicians.

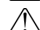
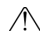
### How To Read These Symbols

Your safety, and the safety of others, is very important. To help you make informed decisions we have provided safety messages and other information throughout this manual.

-  **DANGER** You WILL be KILLED or SERIOUSLY HURT if you don't follow instructions.
-  **WARNING** You CAN be KILLED or SERIOUSLY HURT if you don't follow instructions.
-  **CAUTION** You CAN be HURT if you don't follow instructions.
-  **NOTICE** The purpose of this message is to help prevent damage to your vehicle, other property, or the environment.
-  **NOTE** Things you want to know, things that are useful to know.
-  Follow the instructions of the Service Manual.
-  Follow the other instruction symbols of the "Basic Shop Manual".

### Other Instruction Symbols

The symbols used throughout these instructions show specific "Warnings and Notices". Refer to the "Basic Shop Manual" for the description of each symbol.

# INFORMATION

## ⚠ CAUTION

- To prevent burns, allow the engine, exhaust system, radiator, etc., to cool before installing the accessory.

### NOTE:

- Heat the bonding surfaces with a hair dryer if the ambient air temperature is below 21°C (70°F).
- The adhesive reaches full strength in 72 hours. Wait at least 24 hours before riding your motorcycle.
- Take care not to damage the painted surfaces of the motorcycle.
- Reinstall the removed parts on the motorcycle and make sure that wires and harnesses are not pinched.
- After reconnecting the battery, refer to the Owner's Manual and set the meter.
- After this accessory installation, check the lights (e.g. right/left turn signal lights and brake lights) for proper operation.
- Save all removed parts unless otherwise indicated.

## PARTS LIST

### <USB CHARGER UNIT>

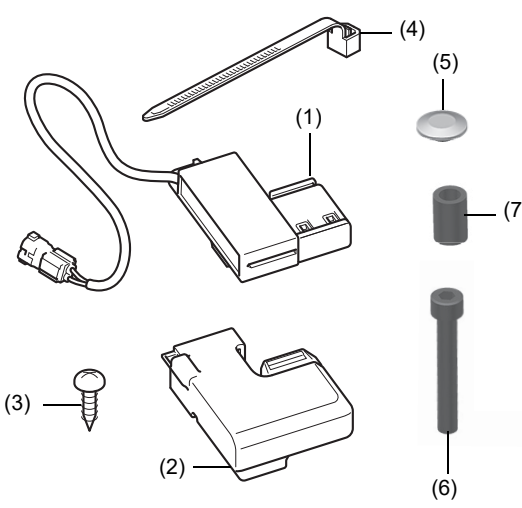
| Component  | No. | Parts Name            | Qty | Parts No.     |
|--|-----|-----------------------|-----|---------------|
|  | (1) | USB charger unit      | 1   | -             |
|  | (2) | Cover                 | 1   | -             |
|  | (3) | 5 x 12 mm screw       | 1   | 93903-25280   |
|  | (4) | Wire tie              | 1   | 35701-MG9-950 |
|  | (5) | Cap                   | 2   | 91456-371-770 |
|  | (6) | 8 x 55 mm socket bolt | 2   | -             |
|  | (7) | Collar                | 2   | -             |

### <USB CHARGER ATTACHMENT>

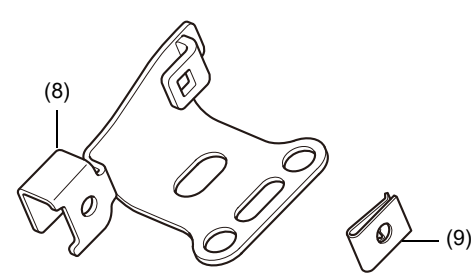
| Component   | No. | Parts Name          | Qty | Parts No. |
|---|-----|---------------------|-----|-----------|
|  | (8) | USB Charger Bracket | 1   | -         |
|   | (9) | Clip nut            | 1   | -         |

# TORQUE INFORMATION

Refer to the Service Manual for the torque values of the removed parts. (📖)

# INSTALLATION

INSTALLATION IMAGE

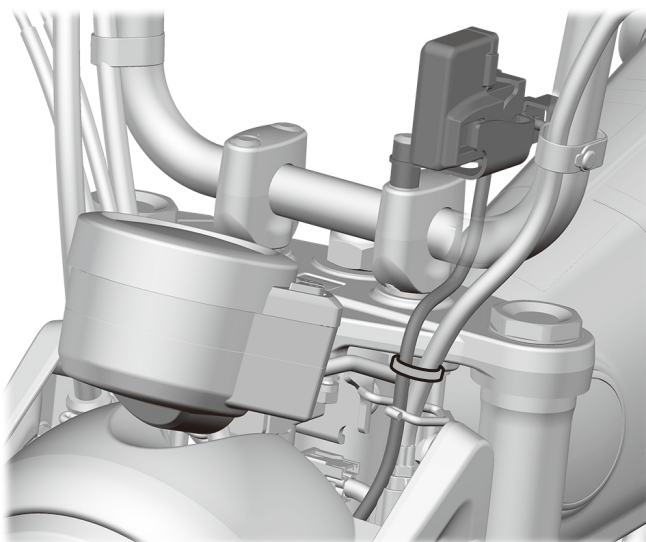

1. Refer to the Service Manual for the motorcycle and remove the motorcycle parts as shown, and disconnect the negative (-) cable from the battery. (📖)

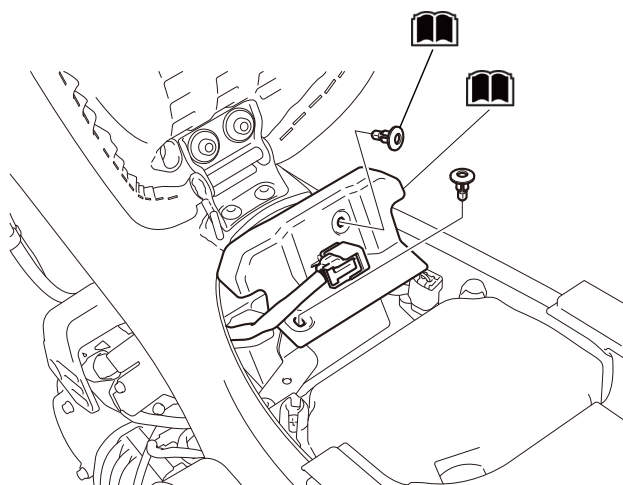

2. Remove as shown. (11)

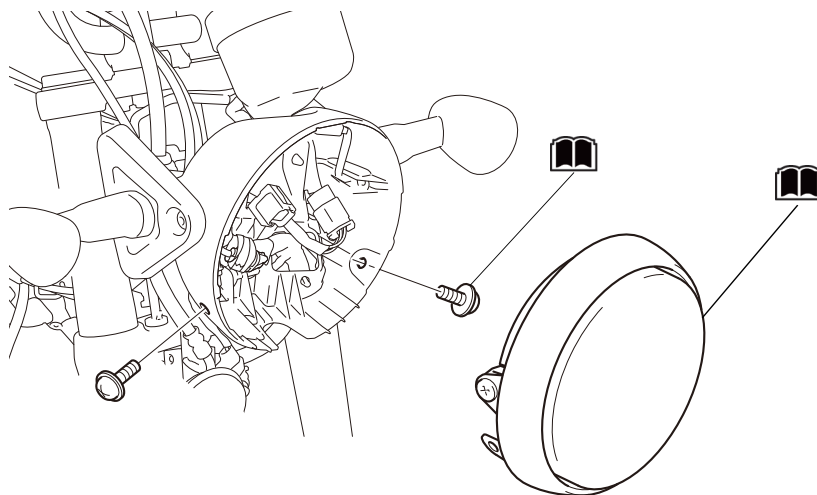

3. Remove as shown.

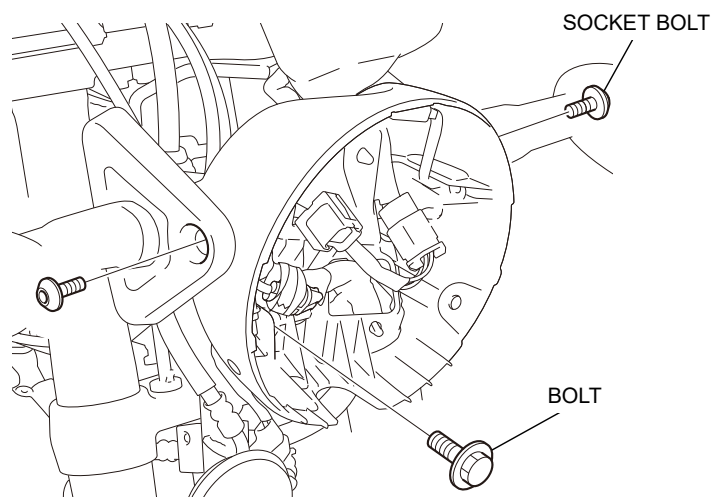

## 4. Install as shown.

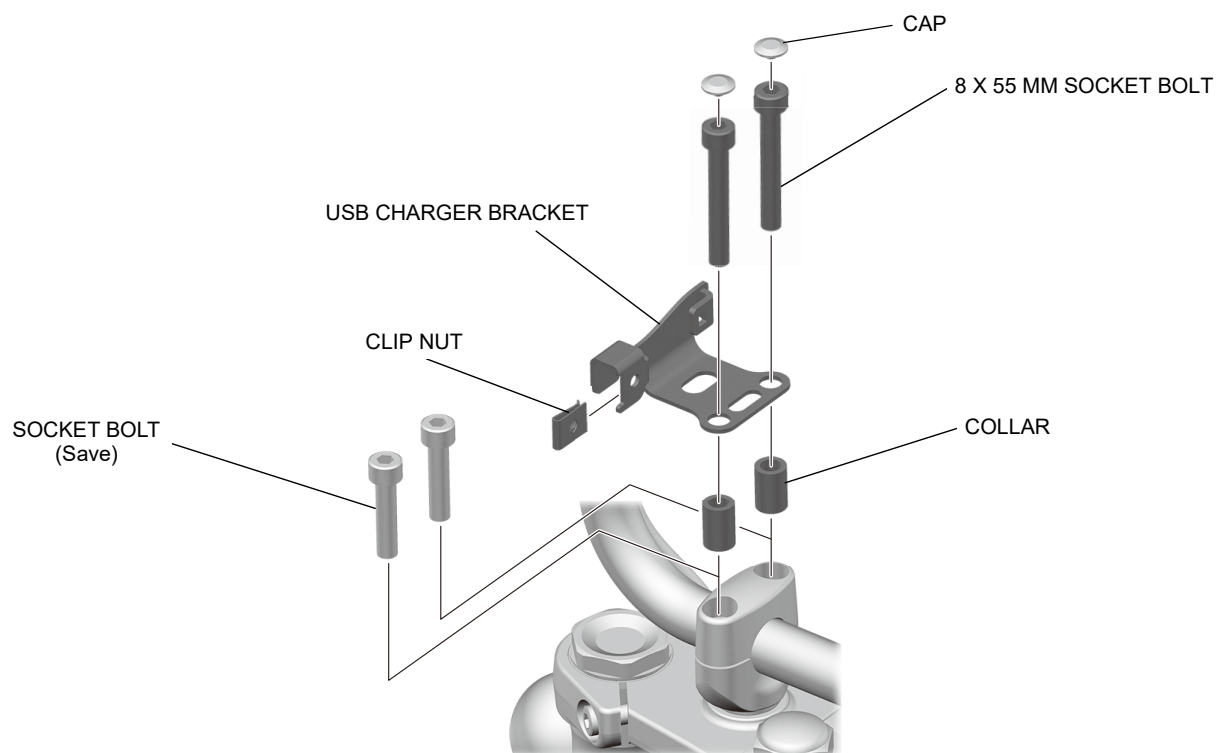

## 5. Install as shown.

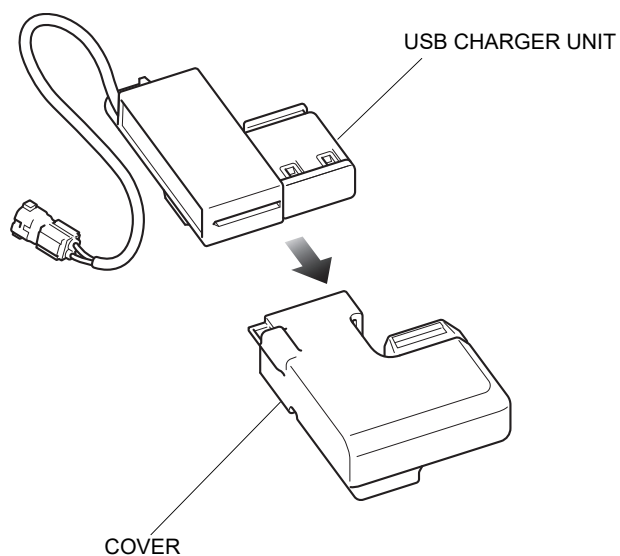

6. Install as shown.

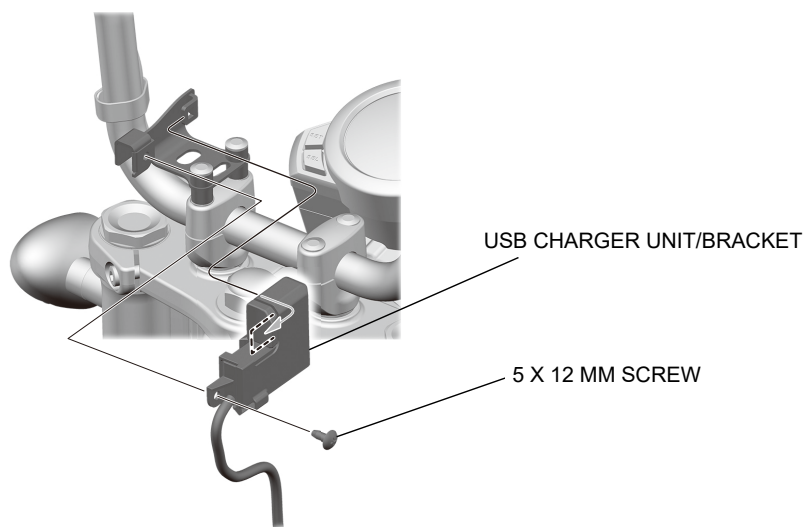

7. Route the harness as shown.

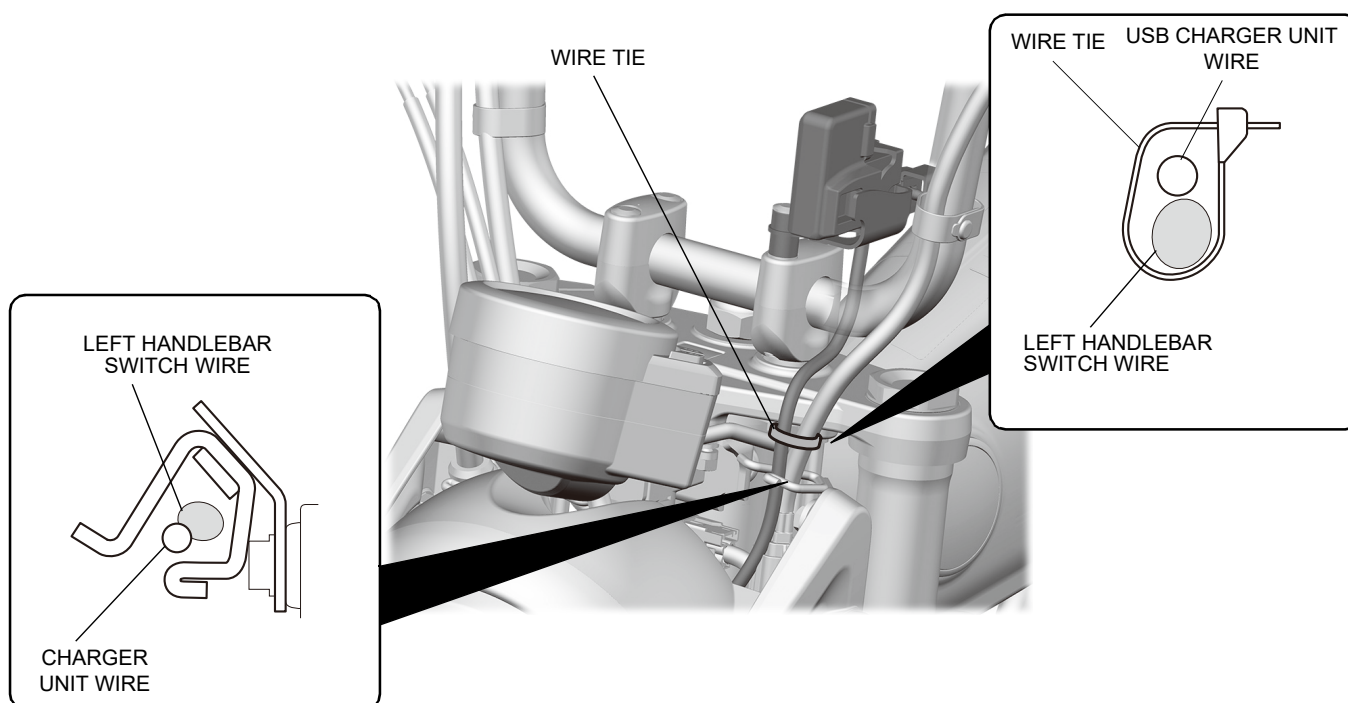

8. Route the harness as shown.

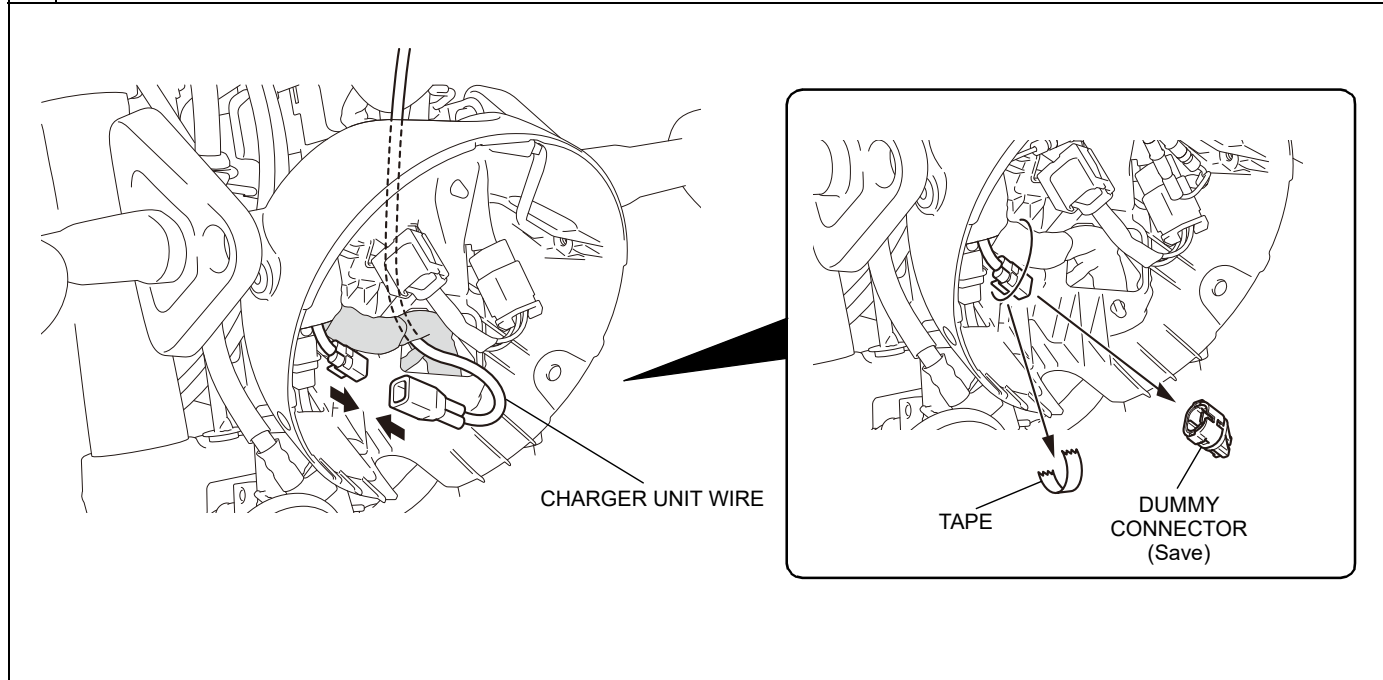

9. Install the motorcycle's parts in the reverse order of removal.
- Confirm that any harness is not caught or too tight.